

Black Route

Figure 5.11 | Mountain Bike Routes

5.5.4 Parkland Bowl

In Transformation, modifications and additions will be made to the structures, landforms and plant communities within the Parkland Bowl. In particular the removal of the temporary bridges will provide opportunity to reduce the width of the bridge approaches and expand the adjacent riparian habitats and species rich meadows. The Bowl has great horticultural and ecological significance which will be further enhanced in Transformation to meet the Biodiversity Action Plan targets. The reduced width of the bridge approaches for F02 and F03 will result in greater area for wet woodlands, frog ponds and landforms. Underneath the F03 approach, a pedestrian underpass will connect the Bowl with Bully Point, the Athletes Village and beyond. Some plant communities will be developed from the display qualities of Games mode to more ecologically rich communities required by the BAP. To further enhance the ecological value of the Bowl, a number of additional wildlife structures will be integrated into the parklands.



Figure 5.12 | Parkland Bowl Plan

5.5.5 Multi-Use Sports Venue

A new public plaza will be created to the north of the handball venue which will form part of the east-west pedestrian stitch linking Walthamstow and Leyton, through the park, to Fish Island via bridges F03 and H10. The Games mode front of house area will be transformed into a landscape linking the north and south parks together. The principal public entrance to the Handball venue shifts in transformation from the two Games mode front of house entrances to the east of the building at the 14.0 metres AOD level, to two entrances on the north side of the building at the 11.0 metres AOD level. The focus of activity around the building on a day-to-day basis therefore shifts to the north with a new plaza space created to accommodate pedestrian movement, cycle parking, blue badge parking and drop-off.

The Games mode spectator entrances will continue to be used for large events at the arena but this will be occasional rather than everyday use. The front of house area will therefore need to continue to accommodate crowds moving to and from the venue, but without the requirement to act as a holding area for spectators. Consequently some of the concourse that forms this area can be transformed into soft landscape through the use of trees and lawn. The proposal is that this front of house area becomes part of the Transformation landscape of green 'bowls and lenses', linking the north and south parks and east and west communities.

5.5.5.1 Integration with Athletes' Village

The design of the permanent parkland in the area by Bully Point has informed, and been informed by, the landscape proposals for the Athletes' Village so that despite being delivered independently the result is a fully integrated and unified parkland. There is a logical route network connecting the Post-Games Transformation Parkland to the Athletes' Village landscape, finished in coordinating materials to ensure a seamless transition from one area to the next. Pedestrian routes connect to the upper F03 level and to the lower wetland level whilst a new connection underneath through the F03 'causeway' connects Bully Point to the Parkland Bowl.

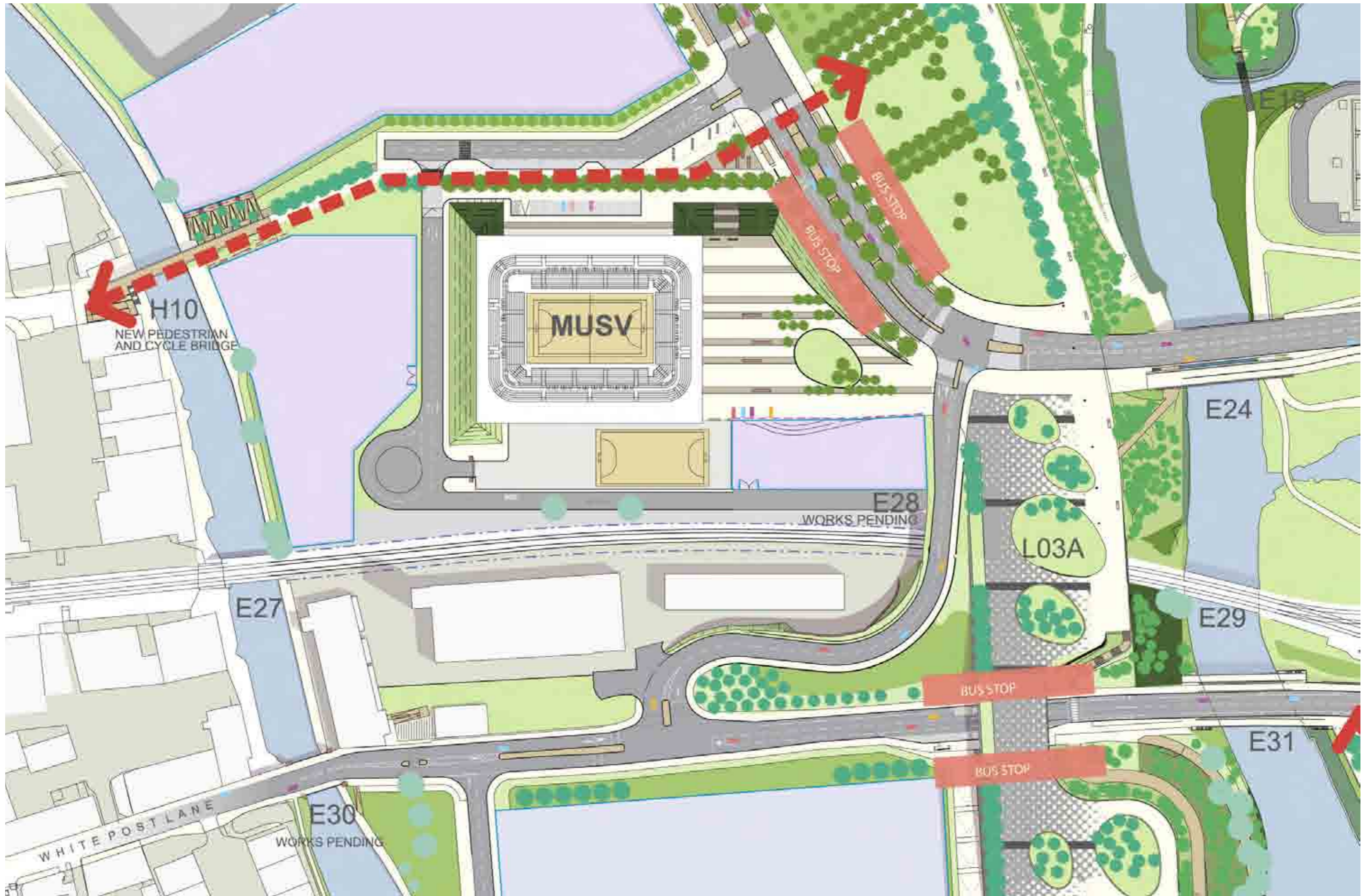

Figure 5.13 | Multi-Use Sport Venue Plan

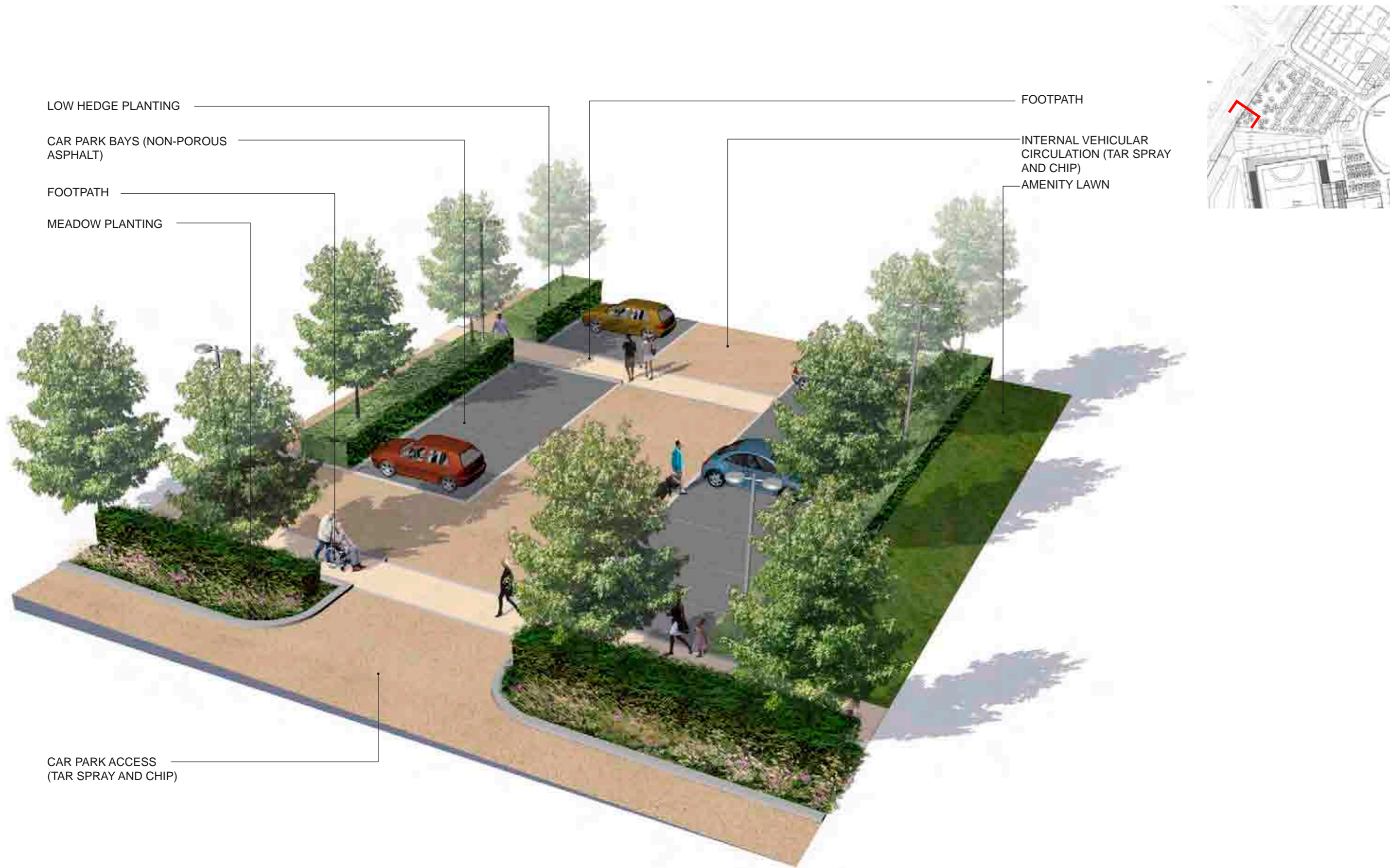
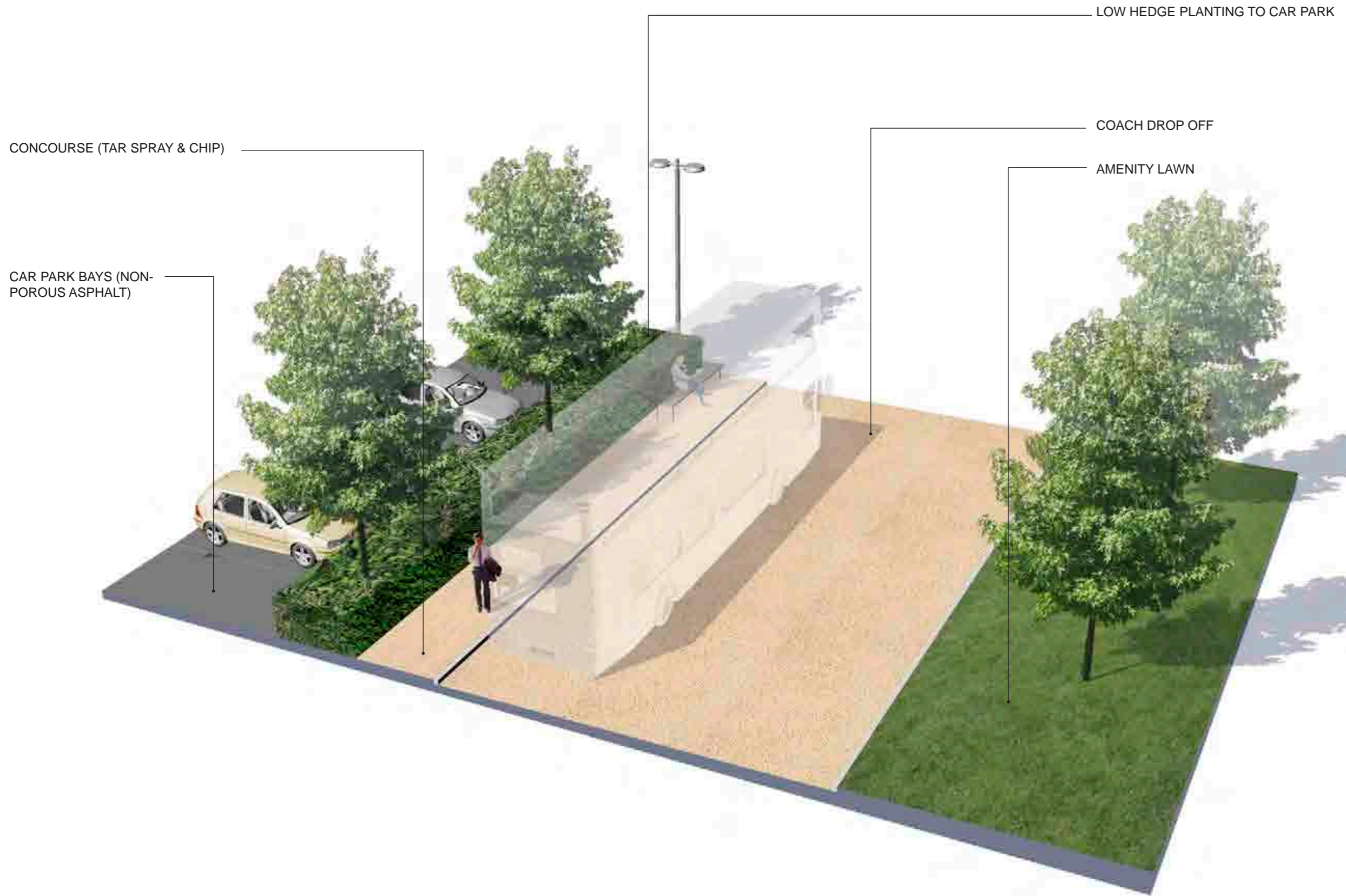

Figure 5.14 | North Park - Eton Manor - Main Car Park Axonometric Diagram

Indicative Illustration Only



Indicative Illustration Only

Figure 5.15 | North Park - Eton Manor - Coach Drop Off Axonometric Diagram

PRIMARY GATED ACCESS TO WIND
TURBINE EXCLUSION ZONE

INTERNAL VEHICULAR CIRCULATION
ACCESS ROAD TO CAR PARK (TAR SPRAY AND
CHIP)

FOOTPATH (TAR SPRAY & CHIP)

LOW HEDGE PLANTING TO CAR PARK

LOW SHRUB
PLANTING

CONCOURSE
(TAR SPRAY & CHIP)

1.5M HIGH HEDGE

1.5M HIGH FENCE
TO WIND TURBINE
EXCLUSION ZONE

SPECIES RICH BROWNFIELD
MEADOW

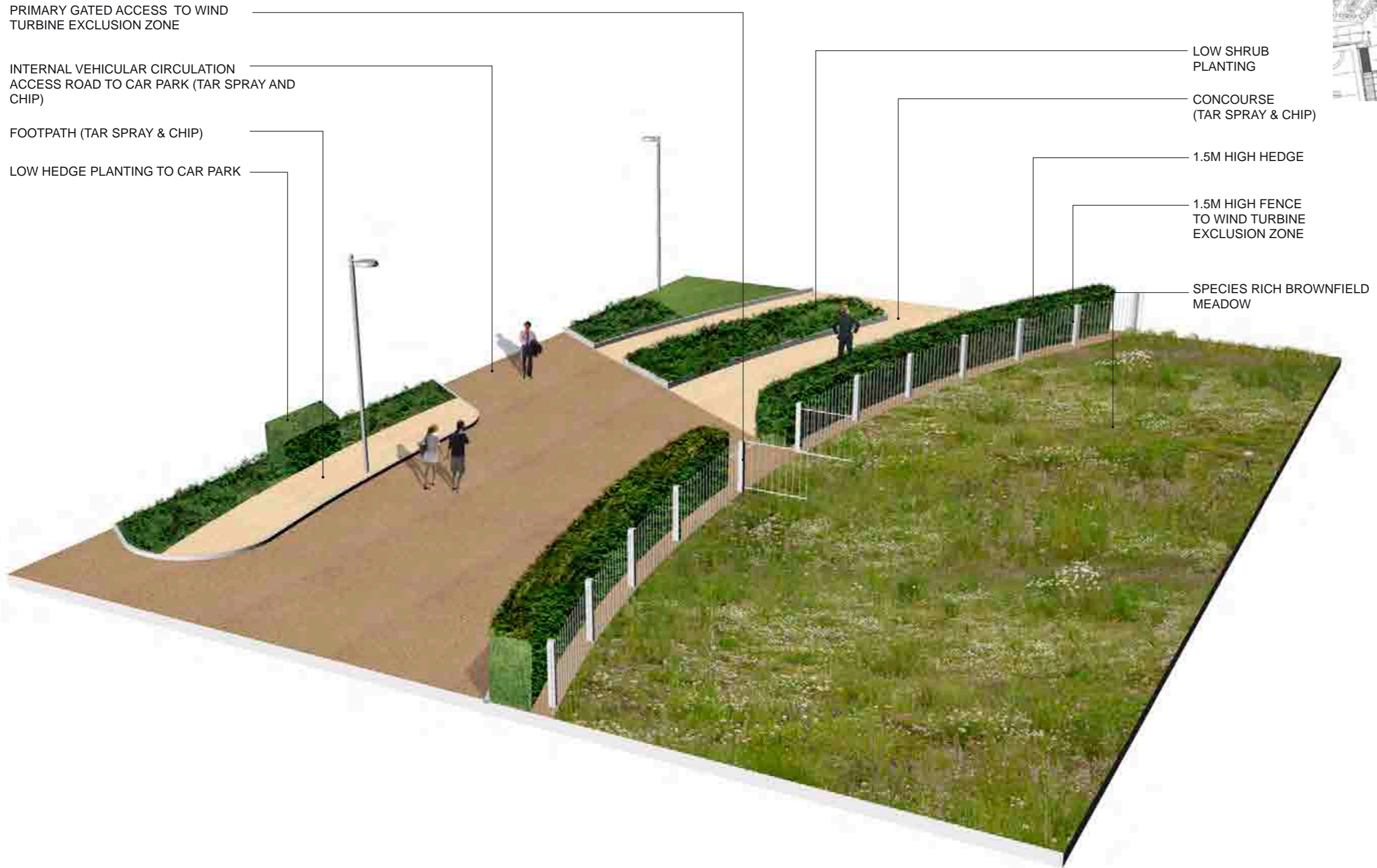
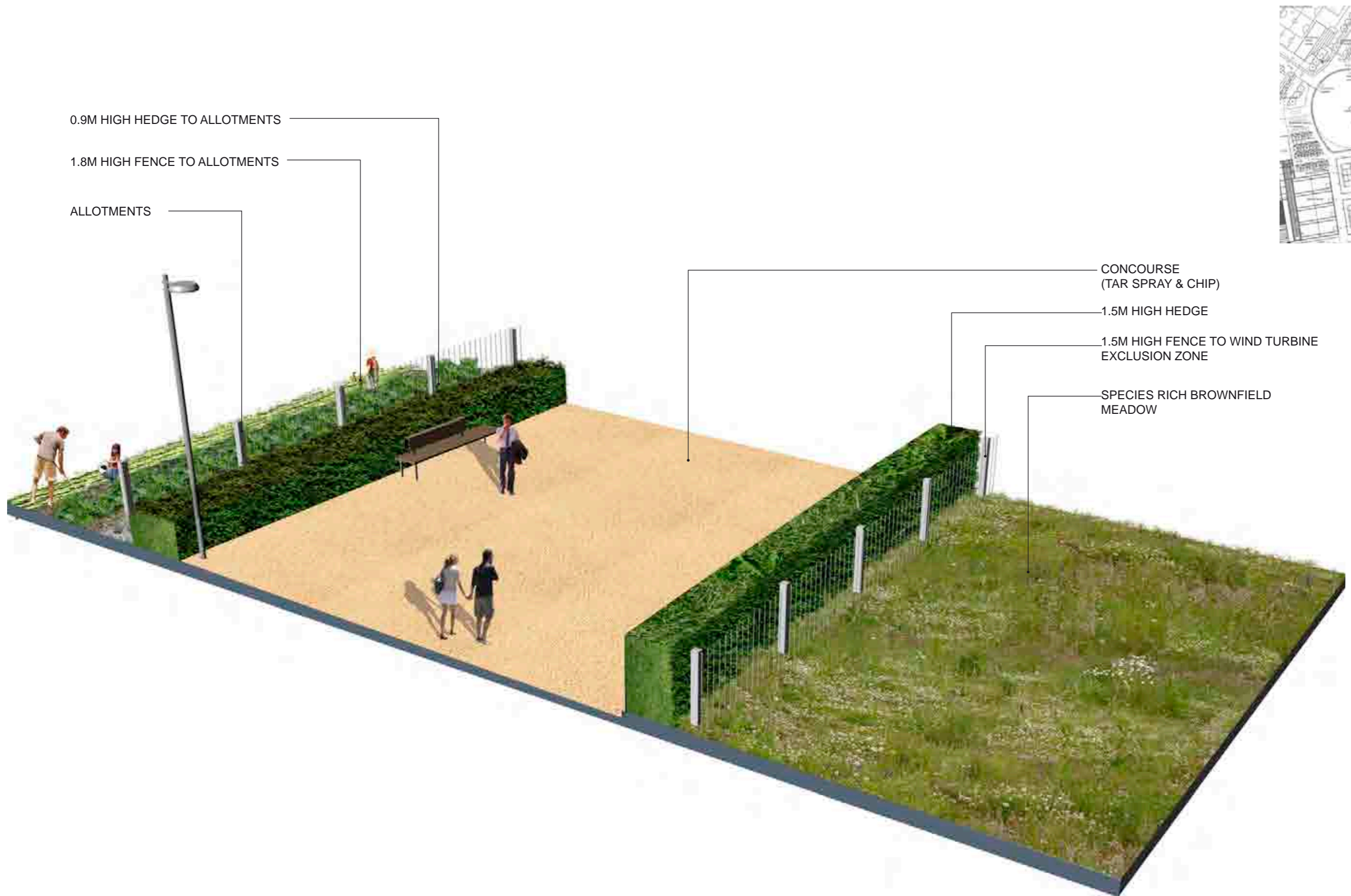

Figure 5.16 | North Park - Eton Manor - Access to Wind Turbine Demise Axonometric Diagram

Indicative Illustration Only



Indicative Illustration Only

Figure 5.17 | North Park - Eton Manor - Relationship between Allotments and Wind Turbine Axonometric Diagram

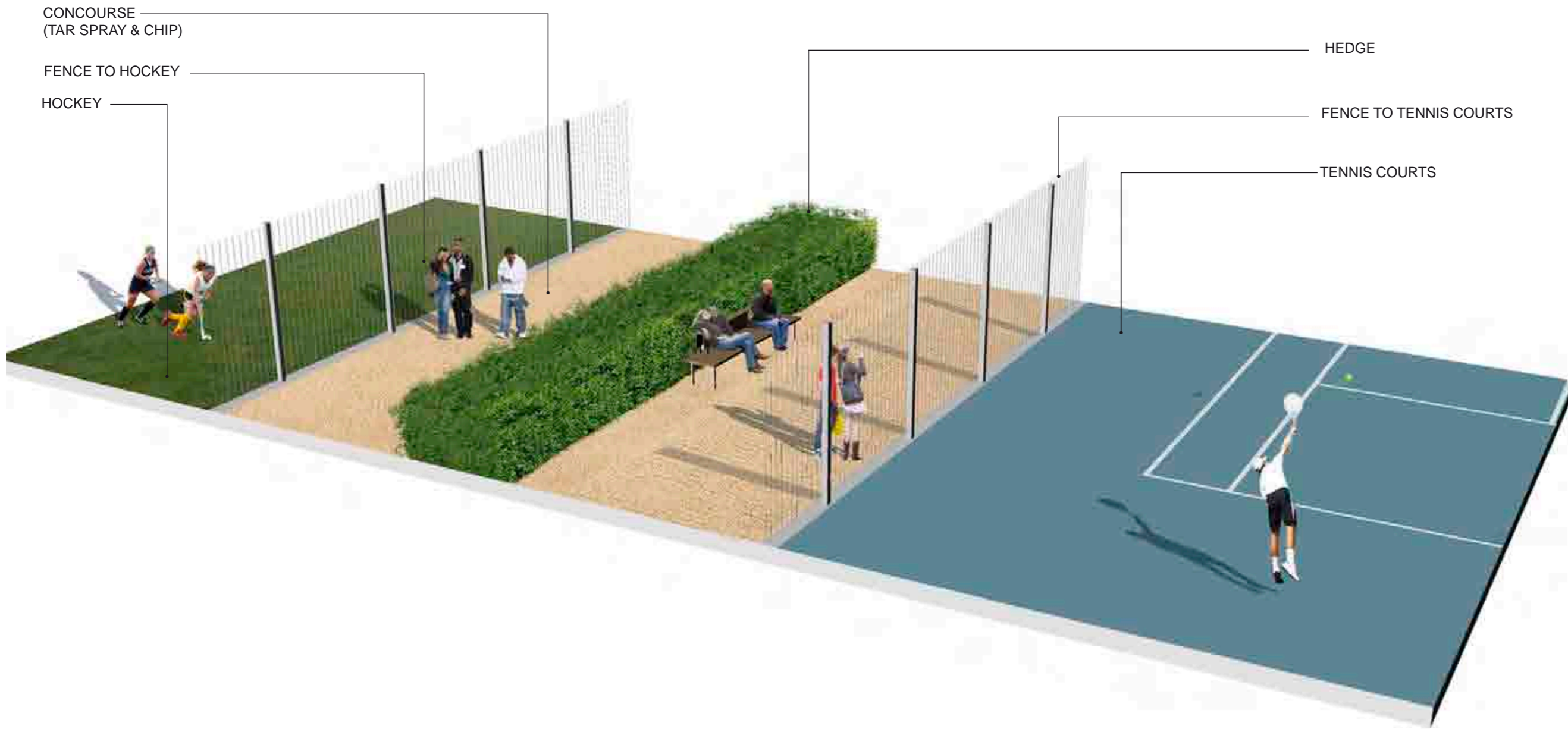
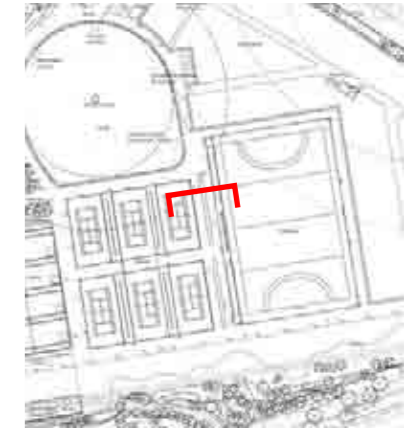

Figure 5.18 | North Park - Eton Manor - Walkway between Hockey and Tennis Axonometric Diagram

Indicative Illustration Only

SMALL TREE GROUPS
ON PERENNIAL MEADOW

SOFT SWALE

TREES GROUPS ON
PERENNIAL MEADOW

MOUNTAIN BIKE TRACK
AREA

NATIVE MIXED
WOODLAND

A12 EASTWAY

EXISTING WALL



Indicative Illustration Only

Figure 5.19 | North Park - Eton Manor - Landform along the A12 Axonometric Diagram